



**ECF is suitable for use with laminate, engineered wood and solid wood.**  
(ECF can be used with attached pad flooring. For all applications, always refer to the Flooring Manufacturer's Installation and Warranty specifications prior to installation.)



**Install the VAPOUR BARRIER FACING UP for all applications:**  
ECF can be utilized in all rooms and floor levels, including basements and condominiums.

**Always Follow Flooring Manufacturer's Preparation and Installation Instructions**

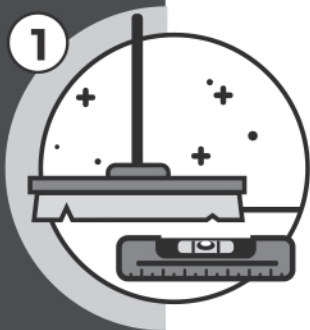

**STEP 1: Wood Subfloor Preparation**

Assure that subfloor is level, free of dust and debris, dry and mould-free. Remove all protruding objects like nails and repair all other defects in the subfloor to create a smooth, even-leveled surface.

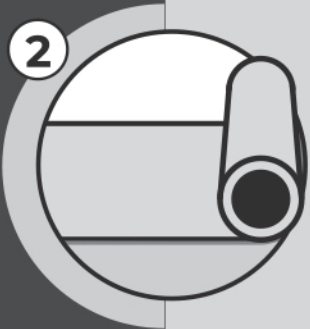

**STEP 2: First Underlayment Laydown**

Start at corner of room and roll out underlayment with the 6 mil vapour barrier facing up towards the ceiling. Fold out the underlayment roll with the overlapping vapour barrier facing the inside of the room in preparation to lay the second underlayment roll. For wood subfloors, it's recommended that the side of the underlayment without the overlap be 0.5" away from the wall. Installing the 6 mil film facing up helps protect the backside of your flooring and preserves the tongue-and-groove connections.

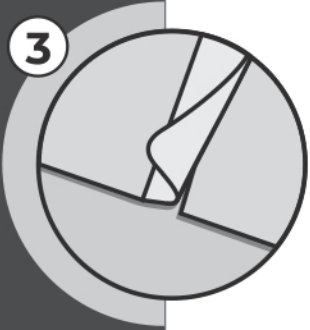

**STEP 3: Subsequent Underlayment Laydown**

Lay the second underlayment alongside the first underlayment and butt the foam seams (non-overlapping vapour barrier) together. Allow the overlapping vapour barrier of the first underlayment to rest on top of the second adjoining underlayment.



**STEP 4: Taping/Sealing Underlayment on All Concrete Subfloors**

Using the peel-and-stick tape included, tape the overlapping vapour barrier film to the adjoining butted underlayment. Along with the tape sealing the length of the underlayment, you should also seal the adjoining ends/perimeter with duct tape to ensure moisture protection.



**Taping/Sealing Underlayment on All Wood Subfloors**

Taping underlayment to join the seams on subfloors is not recommended. The use of any tape to entirely join and seal the length and/or width of an underlayment on wood subfloors may restrict needed airflow, which can potentially create moisture and compromise the integrity of your flooring system.

Staples or nails can be used to secure underlayment to wood subfloors.  
(Refer to flooring manufacturer's guidelines.)

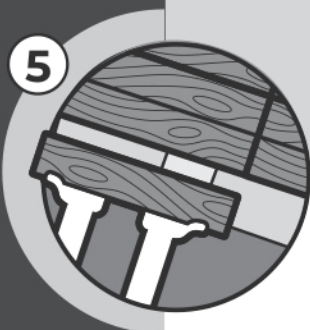

**STEP 5: Install the Flooring**

Install the flooring per manufacturer's instructions.

**Radiant Floor Installation**

Follow both radiant and wood flooring manufacturer's guidelines.

**Glue-Down Installation:** ECF is not recommended for single or double glue-down installation, and such use will void warranty.

For Eco Cork Foam installation and Limited Lifetime Warranty information, contact us at 1-855-810-8922 or visit us at [www.ecfunderlayment.com](http://www.ecfunderlayment.com)

Eco Cork Foam is manufactured in North Carolina U.S.A. and distributed in Canada by PXL Cross Linked Foam Corporation.